

SnowBar Instruction Manual

Please read this instruction manual carefully before using the product and keep it properly.

Catalogue

Precautions for Use	1
Product and Accessories	2
Functional Schematic Diagram	3
Installation Instruction	4
Cartridge Replacement	6
Cartridge Replacement and Reminder	7
RO MATE(optional) installation	9
RO MATE(optional) maintenance and use	11
Trouble Shooting	12
Technical Specifications and Water Treatment Process Flow Diagram	13

Precautions for Use

Attention

- 1.Flush and replace cartridges regularly.
- 2.Do not disassemble parts randomly, it may cause leakage or damage.
- 3.Do not use power supply with disproportional rated voltage.
- 4.Please pull the power plug and cut off the feed water valve before if long term storage.
- 5.Do not store or expose in an environment of 0℃ or below.
- 6.Handle with care when discharging, moving and installing.

Remind

- 1.Please turn off the feed water ball valve and cut off the source water to avoid the “water hammer phenomenon” which may lead to leakage or damage to housings and filters if go out in daytime or after the last use at night. Our company would not take the responsibility of the consequence caused by this situation.
- 2.Please cut off power and source water at once in case troubles occur and ask professional staff to repair.
- 3.Professional staff are advised to replace cartridges.
- 4.It is normal to hear vibration sound when system is producing water.

Note:Water hammer is a pressure surge or wave caused when water in motion is forced to stop or change direction suddenly. When residents in building closes the valve suddenly, a pressure wave propagates in pipeline of building.

Product and Accessories

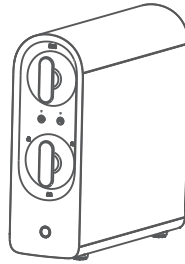
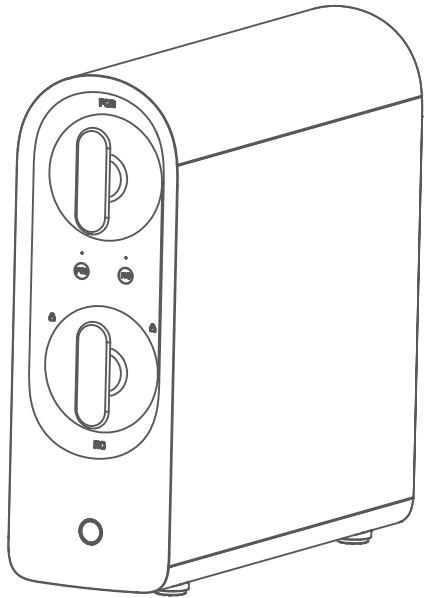

Main Body

Two Filter Cartridges

- 1.PCB filter (PP & CTO)
- 2.Reverse osmosis membrane (RO 800G) / RO membrane combined with post carbon (ROC 600G) /RO membrane (RO 600G)

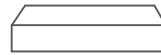

One Accessory Box

Includes faucets,3-way ball valve, Four pipes, instruction book,adapter. Reference images for Accessories

RO mate(optional)

- 1.Quick fitting 1pc
- 2.Main body 1pc
- 3.1/4"PE white pipe 1.5m
- 4.Quick fitting for faucet 1pc

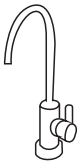
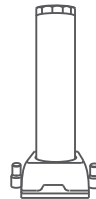

Goose faucet

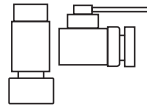

3-way ball valve

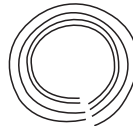

3/8"PE pipe 1.5m(white,blue) 2pcs
1/4"PE pipe 1.5m(red,blue) 2pcs



Instruction book

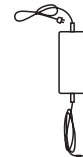

Adapter

Note:

Pictures are for reference only, subject to our available products.

Functional Schematic Diagram

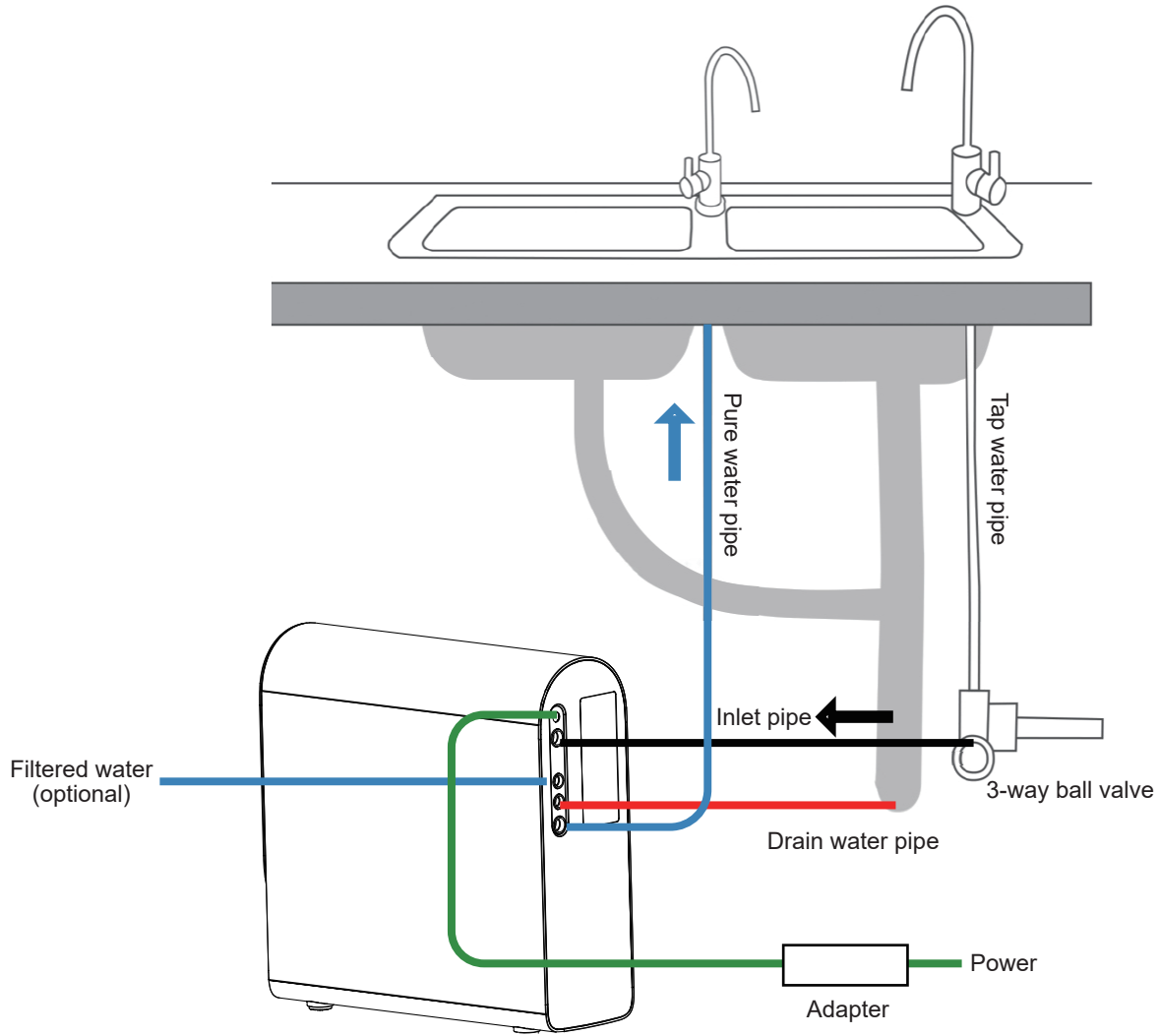

Installation Instruction

TUBE CUTTER NOTICE:



Cut the tube with tube cutter and make it flat and smooth without any burrs.

Quick Fitting

Install the water pipe

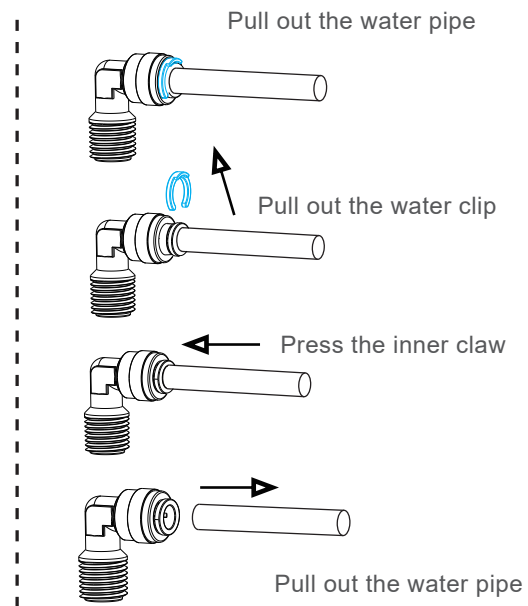
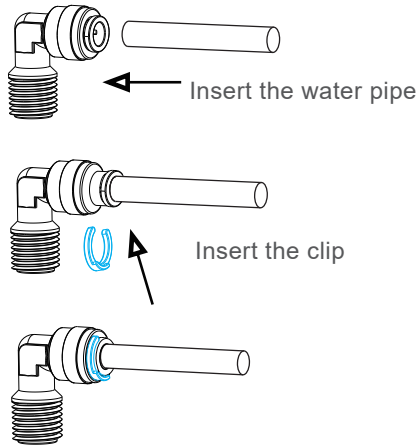

Install diverter valve as per diagram below:

1. Close the feed water valve.
2. Wrap thread of diverter valve with teflon tape.
3. Connect the diverter valve to the feed water valve and the hose(Picture 1).
4. Insert the 3/8" pipe into the diverter valve(Picture 2).
5. Open the feed water valve and the faucet to check whether connection has leakage or not.

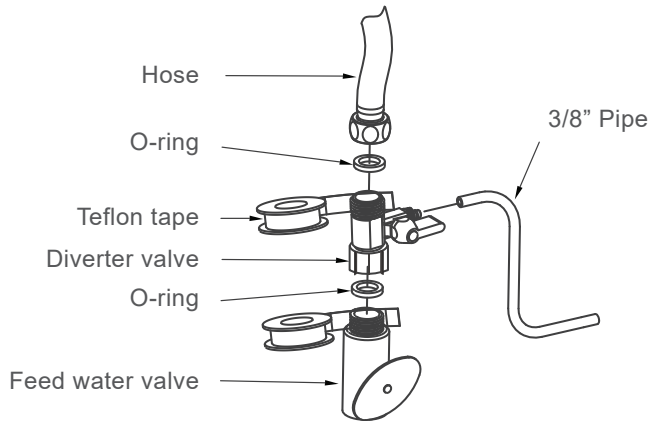

Picture 1

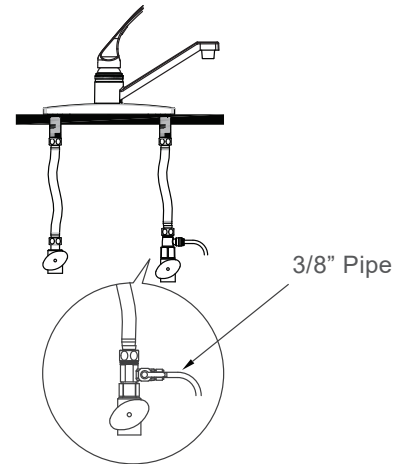

Picture 2

Installation of Goose Faucet

- Select a convenient location near your sink to place the faucet.
- Drill a hole 12mm in diameter in counter top.
- Place washers, plates, seals and nuts in order as per diagram and tighten onto counter.
- Attach Blue Pure Water pipe to the bottom of faucet and connect pipe to unit.

CAUTION: Check if pipe is connected correctly.

Caution: Quick fittings must be assembled properly so as to avoid the water leakage.

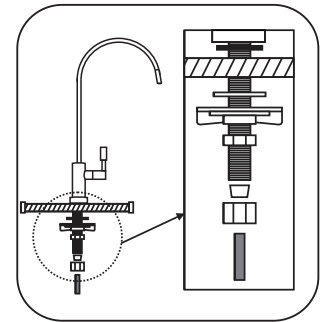

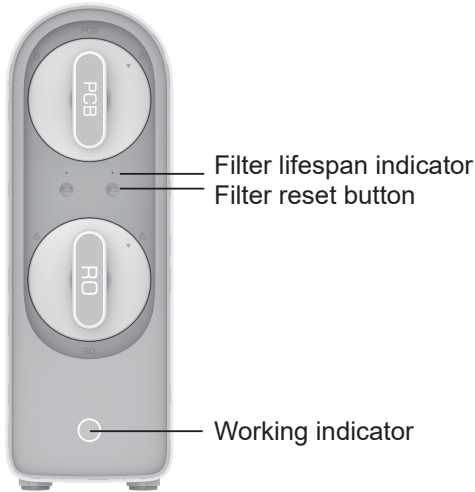

First Use Instruction

- 1.Connect Ro System with adapter,then all LED indicator lights flash 3 times,buzzer rings three times,machine flushes for 90 seconds.
- 2.Ro System begins making water and white flashing Light is on.If machine is standby,only white light is on.
- 3.Yellow Light is on and buzzer rings 4 times while being insufficient water or low water pressure and machine flushes for 15 seconds after having enough water or water pressure
- 4.Red Light flashes and buzzer rings if there is water leakage
- 5.After being working cumulatively for 2 hours,machine will flush 15 seconds automatically.

Note: Under Normal operation,please draw off water For 10~15mins for cartridges flash when it's first use.

Cartridge Replacement

Cartridge reminder

When lifespan is 20% relevant remaining,related LED Light will be on.

Buzzer will ring 3 times,every time the machine is making water.

When lifespan is over,buzzer rings 5 times every time the machine is making water.

Cartridge Reset

Keep pressing both PCB Button and Ro button for 3 seconds to enter selection mode,then press related button for 3 seconds to select the cartridge which needs to be replaced.Relevant Light flashes 3 times and buzzer rings,then cartridge reset is done.The selection mode will exit automatically if there is no operation in 3 seconds.

Cartridge Replacement and Reminder

Stages	Filter Cartridge	Function	Lifespan (for reference only)
The first stage	PCB Filter	PP Filter--removes larger suspended particles in water CTO Filter--removes organics,chlorine,odor and turbidity	3-6months
The second stage	RO membrane (800G)	Removes bacteria,heavy metals,dissolved matters and salinity	12-24months
	ROC filter (600G)	RO membrane combined with post carbon ,which removes the bacteria,heavy metals,dissolved matters and salinity.Meanwhile,it can remove the residual chlorine in water and adjust the taste.	
	RO membrane (600G)	Removes bacteria,heavy metals,dissolved matters and salinity	

Note:

- 1.Actual lifespan of filters can be influenced by areas,water quality,seasons and daily water consumption,so the period of filters replacement may vary.
- 2.Please replace regularly.

Replace the filter element

Please cut off the water and turn off the power before replacing cartridges.

1. Open the Front Cover

2. Hold the cartridge handle and rotate 90° counterclockwise, then pull it out.

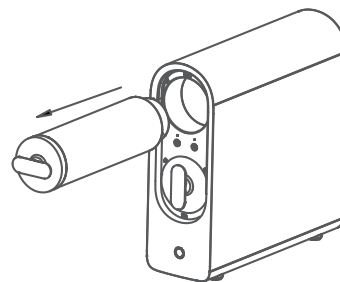
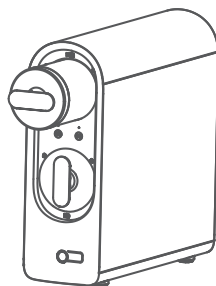
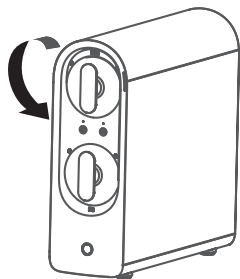

Note: Please reset cartridges after replacement.

3. Replace it with new cartridge and align the arrow label to "☐" and rotate 90° clockwise to "☒"

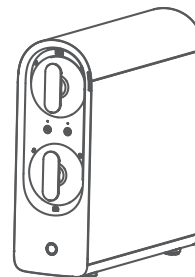
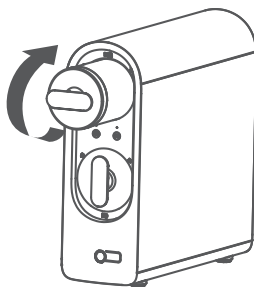
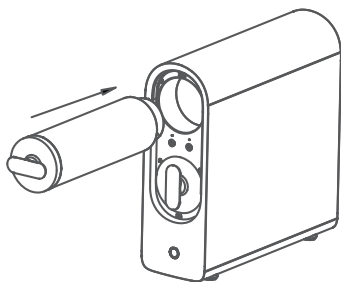

RO MATE(optional) installation

Thank you for purchasing RO MATE.

This filter can be changeable which ensures the excellent filtration function, and moreover,it works under low energy consumption.

This filter is made of sintered coconut shell carbon which can remove chlorine effectively,and has an excellent performance on improving the taste of purified water.

Connection Diagram

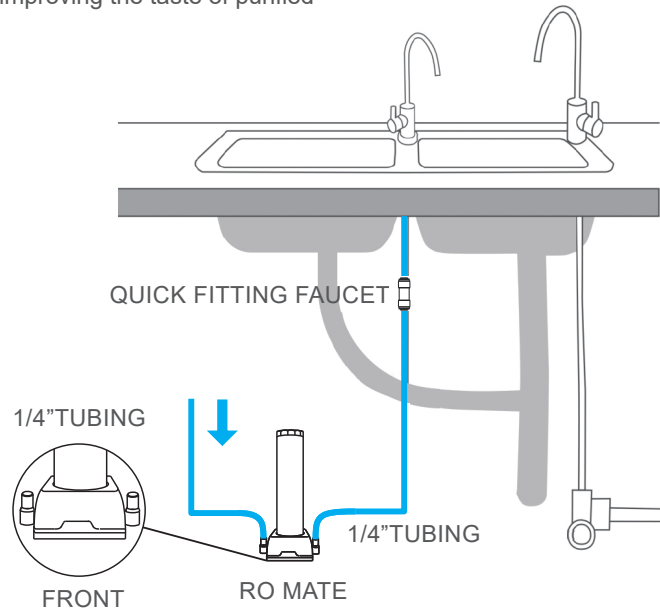

1. Shut off feed water valve of RO SYSTEM,turn on faucet to drain off remaining water from system,power off RO system.

2. Take out RO MATE,and then pull out 2pcs of plugs.After that,put all of them under the kitchen.

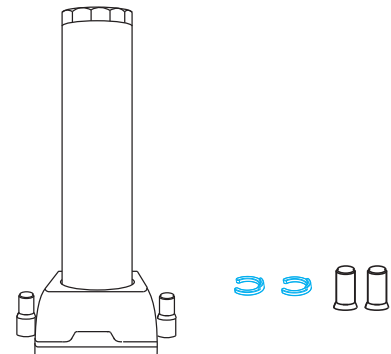

3. Take out the 1/4" TUBING from PACKAGE, cut it into two TUBING by your TUBE CUTTER to make sure it's long enough to connect RO MATE with your faucet & RO MATE with your RO SYSTEM.

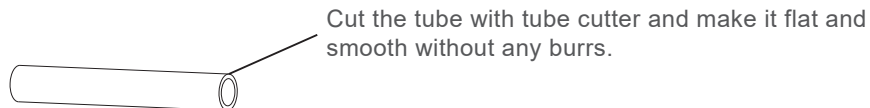

4. Connect ONE TUBING to the left side of RO MATE, then connect it to outlet of RO SYSTEM.

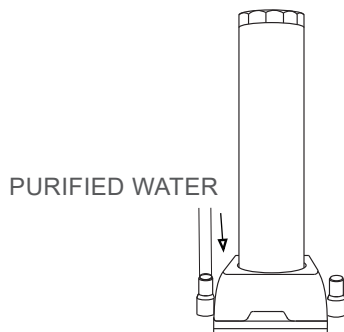

5. Connect ANOTHER ONE TUBING to the right side of RO MATE, then connect it to FAUCET by FAUCET QUICK FITTING from PACKAGE.

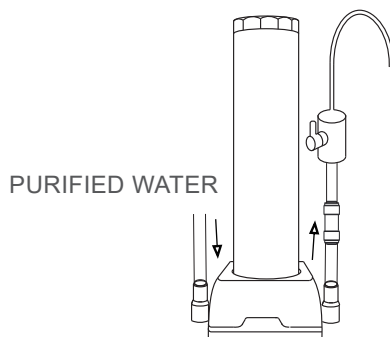

6. Check that all TUBINGS are connected correctly according to CONNECTION DIAGRAM at the beginning of the section.

RO MATE(optional) maintenance and use

For the first use, please flush filter and the method is as follows:

Open the faucet and let water flow out. Keep flushing until output water is visibly clean.

Reminder: there may be a little black water during the first use, but do not worry and it is a normal phenomenon.

Date Dail-up Plate

Mark the filter replacement time and remind you when to replace the filter again.

Operation

After Installation and Filter flushing, you can use the RO MATE. When you need pure water, just open faucet and pure water flows out. After use, just close Faucet and water flow stops.

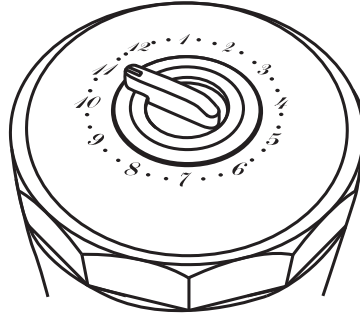

Maintenance

To ensure the unit operate at its optimum level, routine maintenance of replacing the filter is required. The frequency of replacement depends on the inlet water quality and the amount of system usage.

IF THE RO MATE IS INSTALLED AFTER THE RO SYSTEM, IT'S SUGGESTED TO REPLACE THE FILTER AFTER INITIAL SETUP 6MONTHS-12MONTHS. (For actual use, this time depends on the inlet water quality and the amount of water usage)

Filter Replacement

Kindly remind: Please prepare a towel or tissue in case your kitchen gets wet.

- 1.Close Feed Water valve.
- 2.Open Faucet and drain remaining water from the whole system.
- 3.Revolve the old filter clockwise, then take away it from the cap.
- 4.Align the new filter with the central cap, then slightly twist it into the hole.
- 5.Turn counter-clockwise to tighten the new filter then open valves.
- 6.Perform Filter Flushing process after the filter replacement.

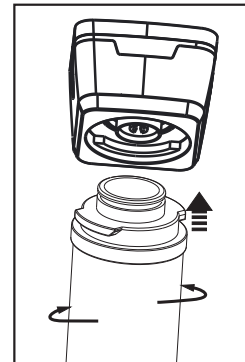

Trouble Shooting

Troubles	Cause	Solution
Water pump is out of service and system does not work	Insufficient feed water pressure	Increase feed water pressure
	No power or power failure	Power-on
	High pressure switch is out of order	Replace high pressure switch
	Pump is blocked and adapter fuse burn-out	Replace adapter and repair water pump
Water pump works but system does not work	RO membrane is blocked	Replace RO membrane
	Water pump pressure loss	Repair water pump
	Flush solenoid valve is damaged	Replace Flush solenoid valve
drain water don't stop when machine is standby	Inlet water solenoid valve damaged	Replace feed water solenoid valve
Cannot stop working when faucet is off or repetitive starting	High pressure switch is damaged	Repair or replace high pressure switch
	Check valve is damaged	Replace Check valve
Leakage	Quick fitting leaks	Check leakage reason, and change the corresponding parts.
	Filter leaks	
	Filter Cap leaks	
No water output	Quick fitting clogged	Replace parts one by one to check the cause of clog.
	Filter clogged	
	Filter Cap clogged	

Technical Specifications and Water Treatment Process Flow Diagram

Technical Specifications

Feed water quality:	Municipal tap water
Voltage& Frequency:	100~240V,50/60Hz
Power input:	150W
Working pressure:	0.5Mpa-0.7Mpa
Water inlet pressure:	0.1Mpa-0.4Mpa
Proper temperature:	5-38 C , Humidity≤90%
Purified water flow :	126L/h (800G) 94.5L/h (600G)

Water Treatment Process Flow Diagram

Technological process

